

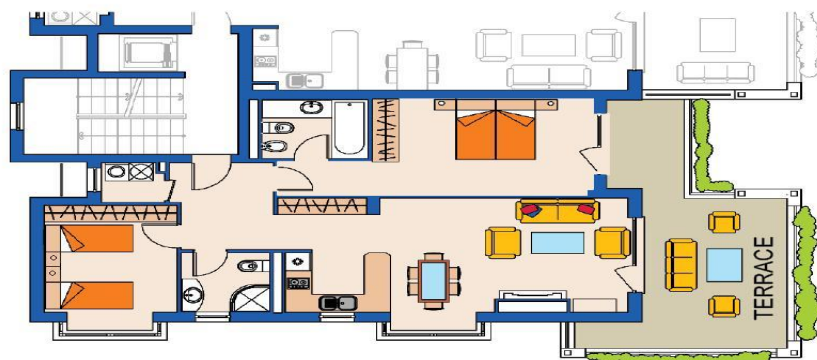

TYPE D



2-bedroom corner apartment

- Living - Dining
- Bedroom 1
- Bedroom 2
- Bathroom 1
- Bathroom 2
- Utility room

Drawing not in scale, refer to the apartment number in the table.

| Apt No. | Floor | Description | Bedrooms | Bathroom | Areas | Area / m2 | Total Area m2 | Price / m2 | Net Price (EURO) |
|---------|-----------|-----------------------|----------|----------|--------------|-----------|---------------|------------|------------------|
| 12A | 1st Floor | Two-bedroom apartment | 2 | 2 | Covered area | 97.41 | 145.32 | 448 | 65 000 |
| | | | | | Terraces | 37.91 | | | |
| | | | | | Common areas | 10.00 | | | |

Maintenance of the building and the common parts:

Studio: 650 EUR

One-bedroom apartment: 920 EUR

Two-bedroom apartment: 1190 EUR

Three-bedroom: 1370 EUR